

North Airways District

# 2320 - 35th Avenue NE

Bay 4, Calgary, AB

## FOR LEASE

Available	Net Rate	Op Costs
Bay 4	4,800 SF \$14.00 PSF	\$5.25 PSF

- Available: 30 Days
- Parking: Ample
- Bay Doors: 1 Dock door | 1 Drive-in
- Power: 200 amps
- Ceiling: 18'
- Year Built: 1976
- District: North Airways
- Zoning: I-G (Industrial General)



1 Dock & 1 Drive-in Door



Gated Back Yard

**Blackstone**  
 Unit A210, 9705 Horton Road SW,  
 Calgary, Alberta, T2V 2X5  
 P (403) 214-2344  
[www.blackstonecommercial.com](http://www.blackstonecommercial.com)

For Leasing or Sales Information Or An On-Site Tour Please Contact  
 Sam Alein | P (403) 398-7183 | [salein@BlackstoneCommercial.com](mailto:salein@BlackstoneCommercial.com)

# 2320 - 35th Avenue NE

Bay 4, Calgary, AB

## Floor Plan

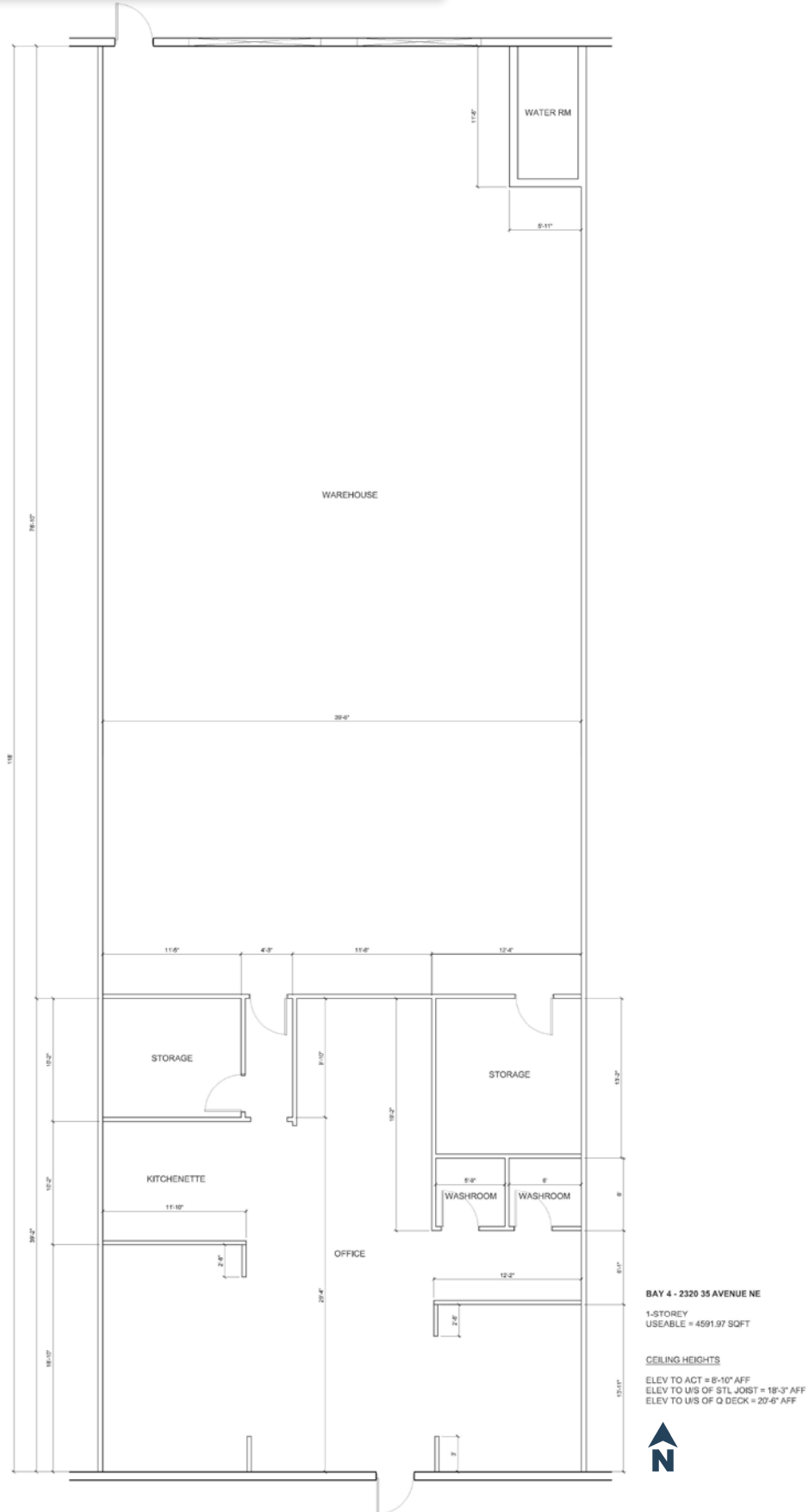



# 2320 - 35th Avenue NE

Bay 4, Calgary, AB

