

**Blackstone**

# For Lease

2440 Division Avenue NW | Medicine Hat, AB

**Retail Adjacent to Family Leisure Centre**

## Northpointe Crossing



**Paul Ramikie**

Lead Broker

P 403.930.8642

E pramikie@blackstonecommercial.com

**Mahmud Rahman**

VP /Associate

P 403.930.8651

E mrahman@blackstonecommercial.com

**Randy Wiens**

Senior Associate

P 403.930.8649

E rwiens@blackstonecommercial.com

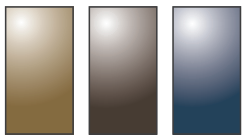

**Blackstone**

# For Lease

2440 Division Avenue NW | Medicine Hat, AB

## Retail Adjacent to Family Leisure Centre

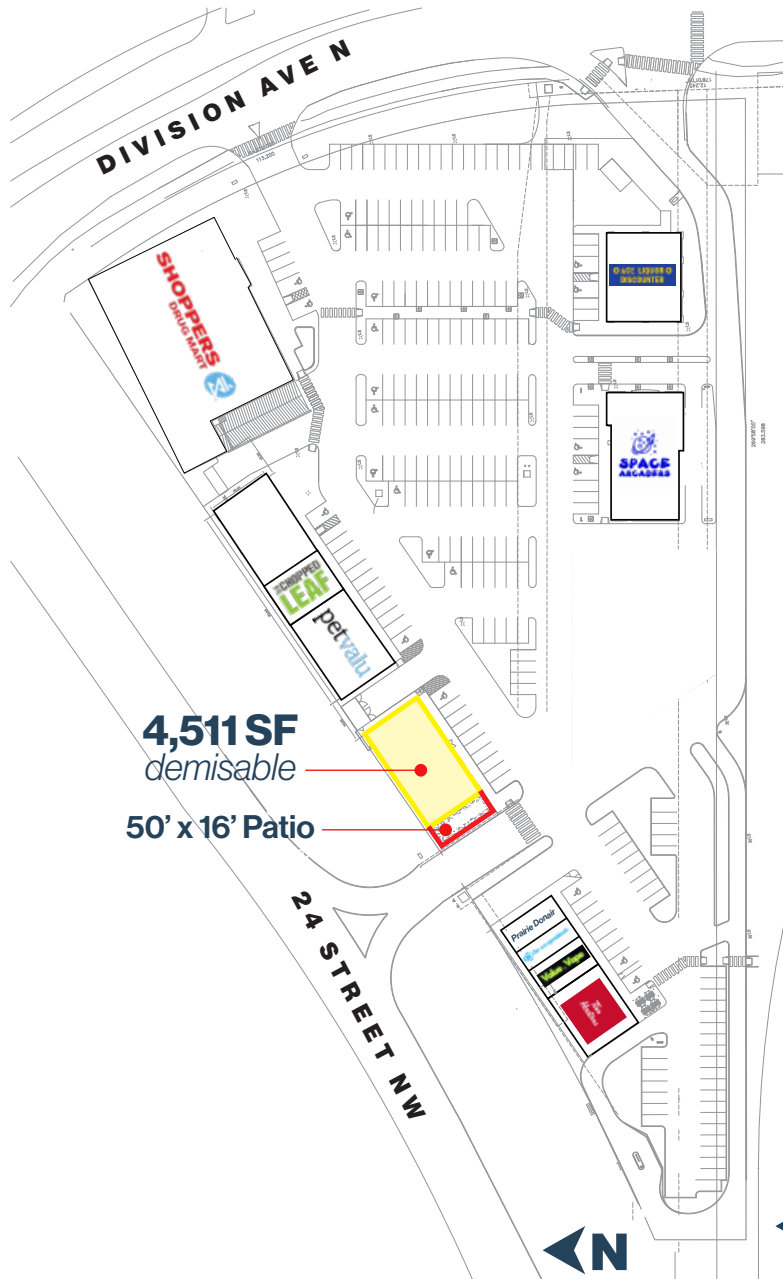

<b>Size Available</b>	1,100 SF – 4,511 SF
<b>Availability</b>	Immediately
<b>Net Rate</b>	Market
<b>Op Costs</b>	\$13.00 PSF (Est.)
<b>Zoning</b>	Mixed-use
<b>Parking</b>	Ample / open
<b>Highlights</b>	<ul style="list-style-type: none"> <li>• High visibility end-cap and standalone options available</li> <li>• Neighbourhood centre anchored by Shoppers Drug Mart and Shadow anchored by Co-op grocery</li> <li>• Located immediately adjacent to Medicine Hat Family Leisure Centre and surrounded by residential density</li> <li>• Northpointe Crossing services over 16,500 residents and draws from Box Springs Business Park and the town of Redcliff</li> <li>• Target tenants: Daycare, Dental, QSR, Hair Salon or Nail Salon</li> </ul>

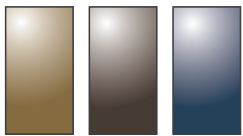

**Blackstone**

# For Lease

2440 Division Avenue NW | Medicine Hat, AB

**Retail Adjacent to Family Leisure Centre**

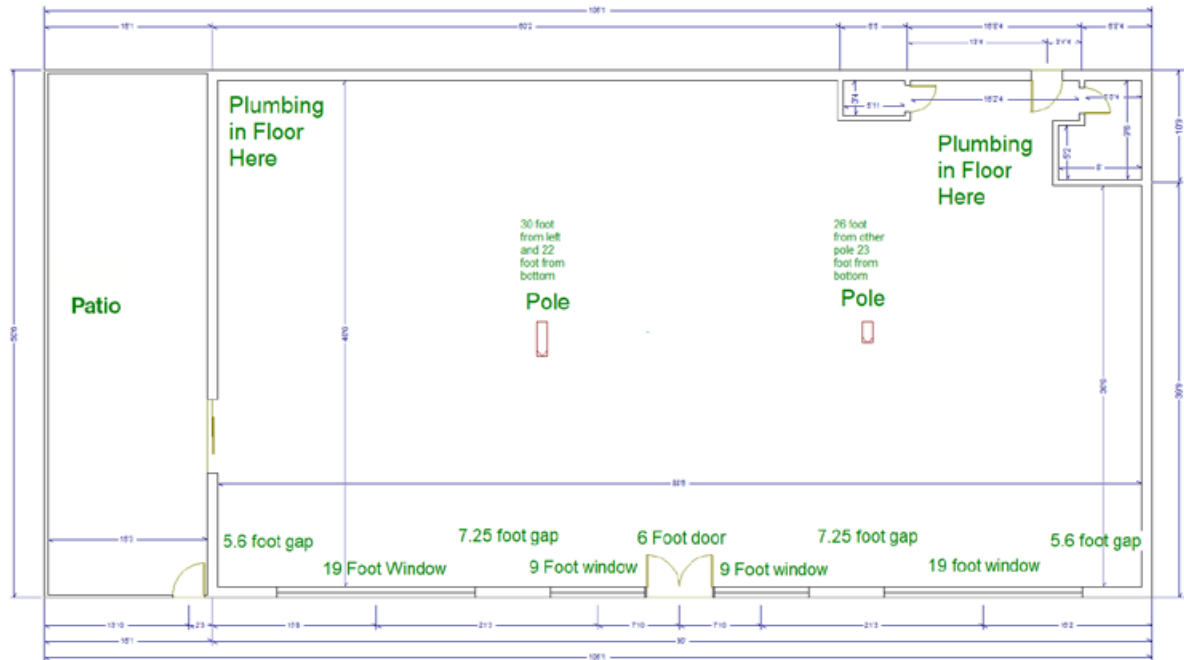

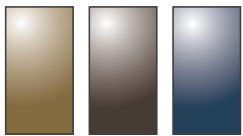

Blackstone

# For Lease

2440 Division Avenue NW | Medicine Hat, AB  
Retail Adjacent to Family Leisure Centre



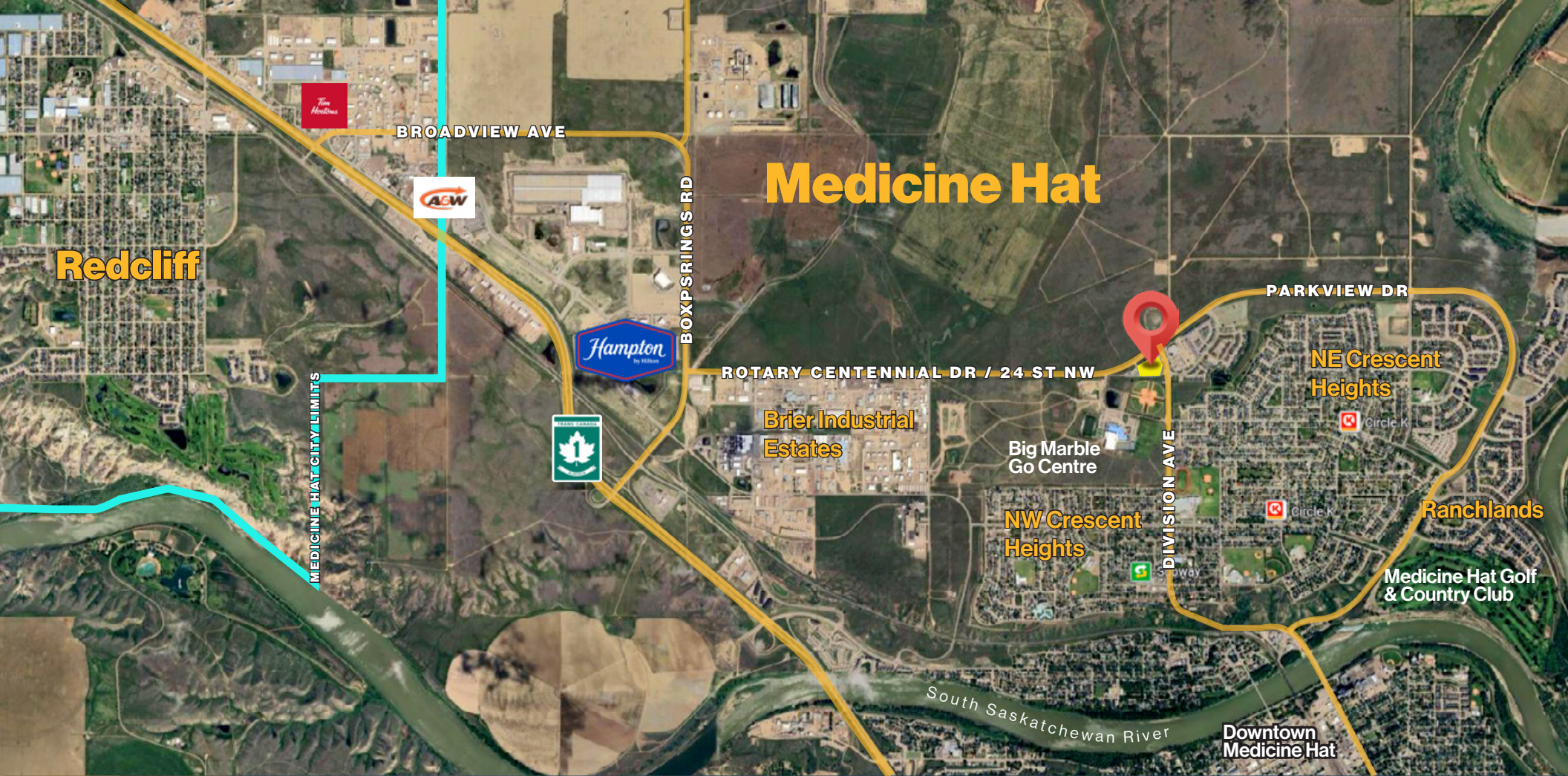

# Medicine Hat

Redcliff

BROADVIEW AVE



BOXSPRINGS RD



ROTARY CENTENNIAL DR / 24 ST NW

Brier Industrial Estates

Big Marble Go Centre

NW Crescent Heights

PARKVIEW DR

NE Crescent Heights



Ranchlands

Medicine Hat Golf & Country Club

Downtown Medicine Hat

South Saskatchewan River

MEDICINE HAT CITY LIMITS



**NEIGHBORHOOD**  
Medicine Hat



**POPULATION**  
3KM  
17,367



**MEDIAN AGE**  
42.1



**HOUSEHOLD INCOME**  
\$70,863



**TRAFFIC COUNT**  
21,660 VPD | Trans-Canada & Boxsprings Rd

**Paul Ramikie**

Lead Broker  
P 403.930.8642  
E pramikie@blackstonecommercial.com

**Mahmud Rahman**

VP / Associate  
P 403.930.8651  
E mrahman@blackstonecommercial.com

**Randy Wiens**

Senior Associate  
P 403.930.8649  
E rwiens@blackstonecommercial.com

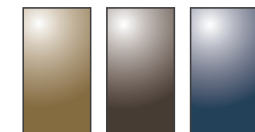

**Blackstone**

# Thank you for your Interest



**BlackstoneCommercial.com**

This document has been prepared by Blackstone Commercial for advertising and general information only. Although information has been obtained from sources deemed reliable, Blackstone Commercial and / or their representatives, brokers or agents make no guarantees, representations or warranties of any kind, expressed or implied, regarding the information including, but not limited to, warranties of content, accuracy and reliability. Blackstone Commercial excludes unequivocally all inferred or implied terms, conditions and warranties arising out of this document and excludes all liability for loss and damages arising therefrom. © 2025, All rights reserved. This document is the copyrighted property of Blackstone Commercial.



**Paul Ramikie**

*Lead Broker*

**P** 403.930.8642

**E** [pramikie@blackstonecommercial.com](mailto:pramikie@blackstonecommercial.com)

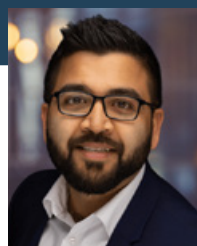

**Mahmud Rahman**

*VP /Associate*

**P** 403.930.8651

**E** [mrahman@blackstonecommercial.com](mailto:mrahman@blackstonecommercial.com)



**Randy Wiens**

*Senior Associate*

**P** 403.930.8649

**E** [rwiens@blackstonecommercial.com](mailto:rwiens@blackstonecommercial.com)